

# SR2000 PRO ROTARY SPREADER

The  
Andersons®

## TABLE OF CONTENTS

Assembly Parts List	1
Assembly	2-5
Calibration	6-7
Operating	8
Parts Overview	9-10
Warranty	11



**3 YEAR LIMITED  
WARRANTY!**

## ASSEMBLY PARTS LIST

**Drawings not to scale**

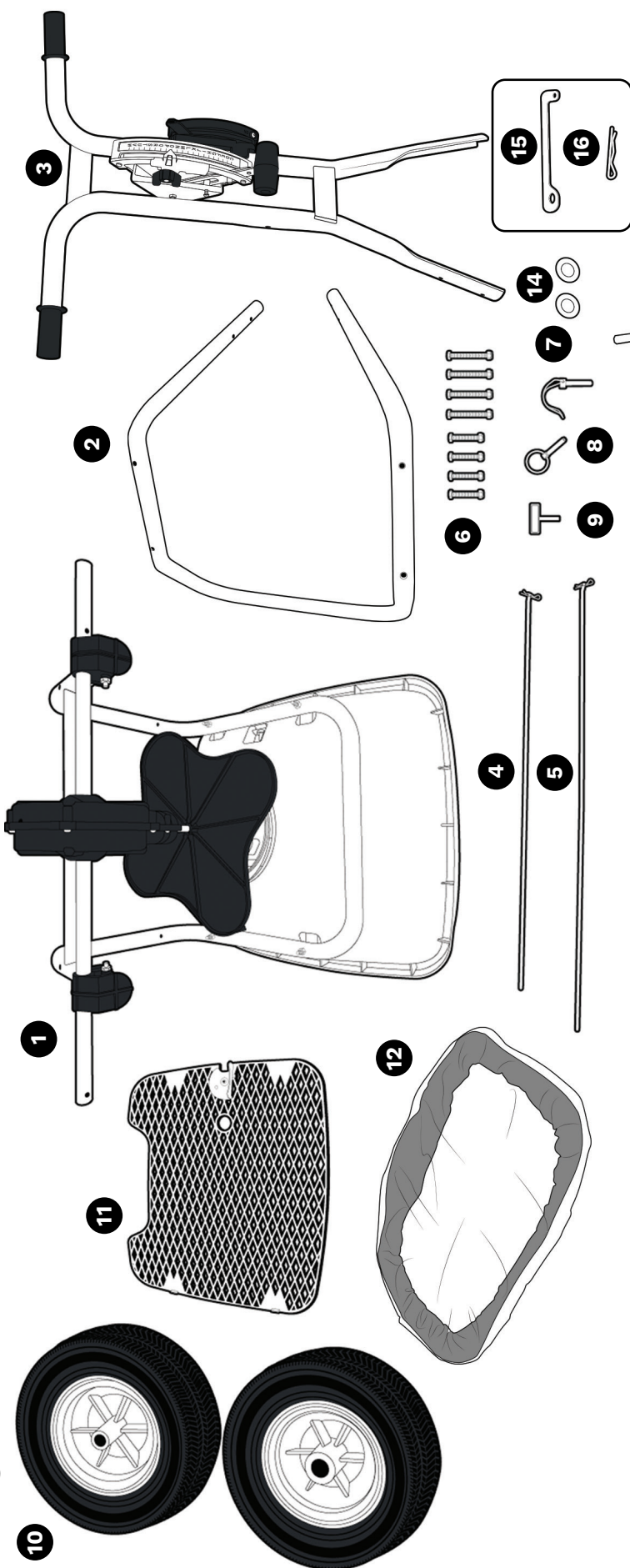

## BOX CONTENTS:

- |   |  |                                   |
|---|--|-----------------------------------|
| <b>1.</b> MAIN HOPPER & GEAR BOX ASSEMBLY | <b>7.</b> DRIVE WHEEL LYNCH PIN        | <b>13.</b> ALLEN KEY              |
| <b>2.</b> BACK STAND                      | <b>8.</b> COAST WHEEL LYNCH PIN        | <b>14.</b> AXLE WASHERS           |
| <b>3.</b> HANDLE ASSEMBLY                 | <b>9.</b> ANDERSONS<br>CALIBRATION KEY | <b>15.</b> EDGEWISE™<br>PIVOT ROD |
| <b>4.</b> EDGEWISE™ CONTROL ROD (SHORT)   | <b>10.</b> 2 x WHEELS                  | <b>16.</b> R PIN                  |
| <b>5.</b> CONTROL ROD (LONG)              | <b>11.</b> SCREEN                      |                                   |
| <b>6.</b> 8 x BOLTS & LOCK NUTS           | <b>12.</b> HOPPER COVER                |                                   |

**TOOLS REQUIRED  
FOR ASSEMBLY:**

2 x 10 mm WRENCH

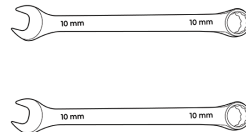

## 15. EDGEWISE™ PIVOT ROD

## 16. R PIN

## ASSEMBLY

1

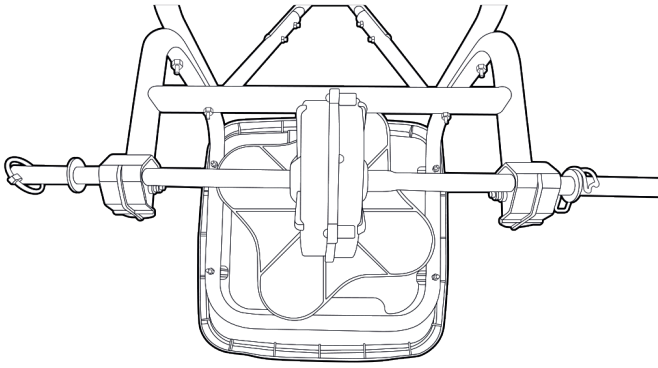

Invert the spreader hopper on a work bench as shown (1).

2

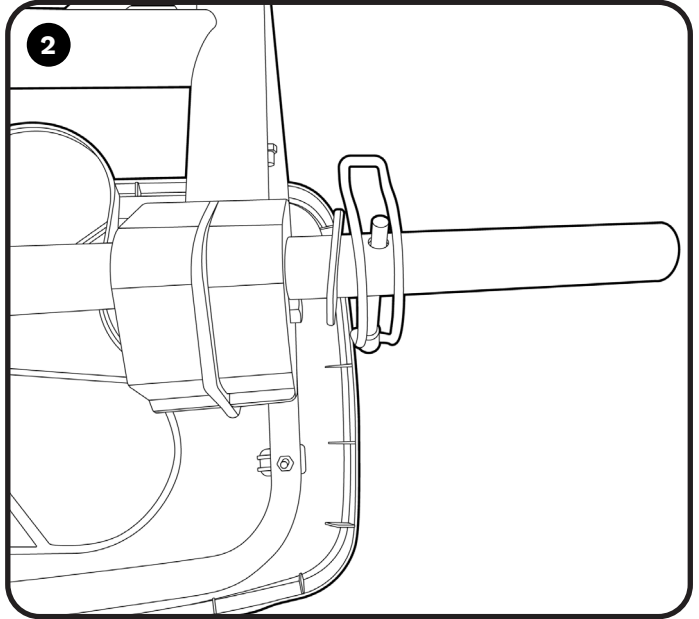

Locate and remove drive wheel lynch pin. Leave the washer in place.

3

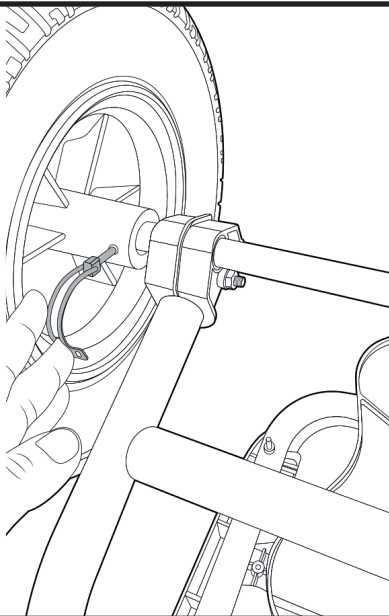

Locate the drive wheel onto the axle. Align the hole in the wheel hub and the hole in the axle. Push the drive wheel lynch pin through the holes and press down the clamp to secure.

4

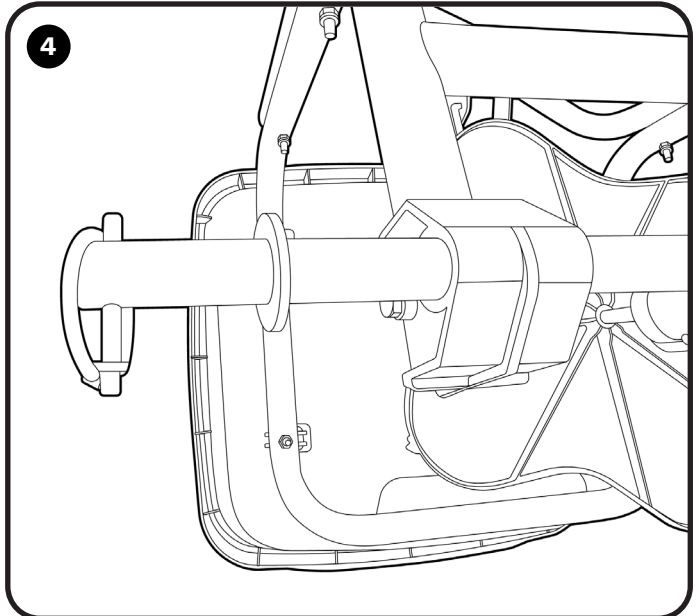

Locate and remove coast wheel lynch pin. Leave the washer in place.

## ASSEMBLY

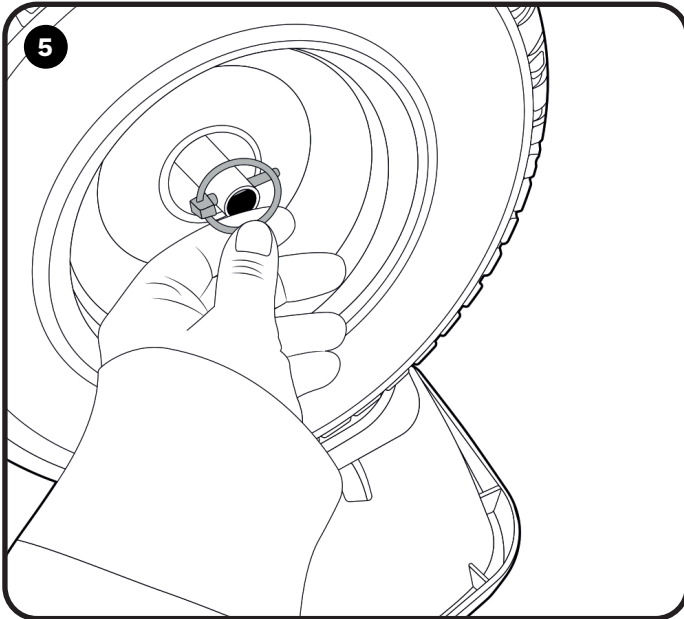

Secure the coast wheel in place using the coast wheel lynch pin placing it through the axle end hole as shown.

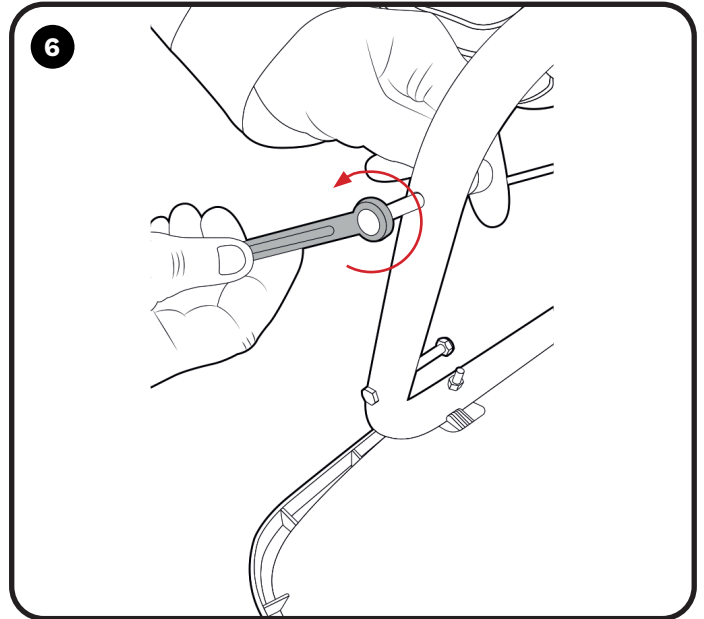

Undo the 4 bolts on the main frame as shown.

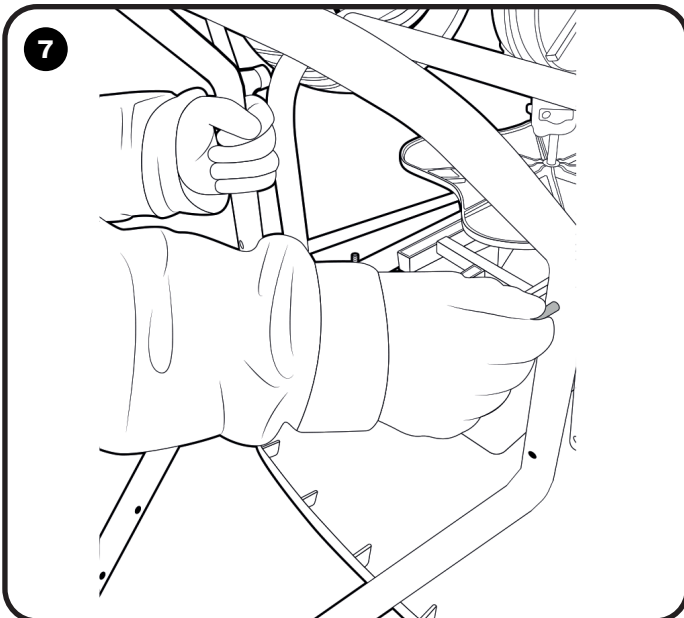

Take the back stand (2) and align the holes from the back stand with those on the frame (1). Reinstall the bolts as shown in picture 8.

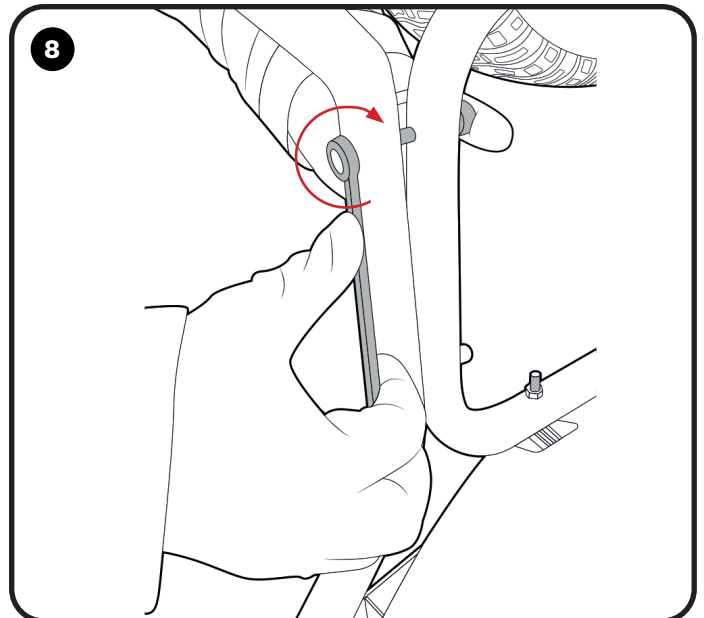

Tighten all 4 bolts to secure back stand in place.

# ASSEMBLY

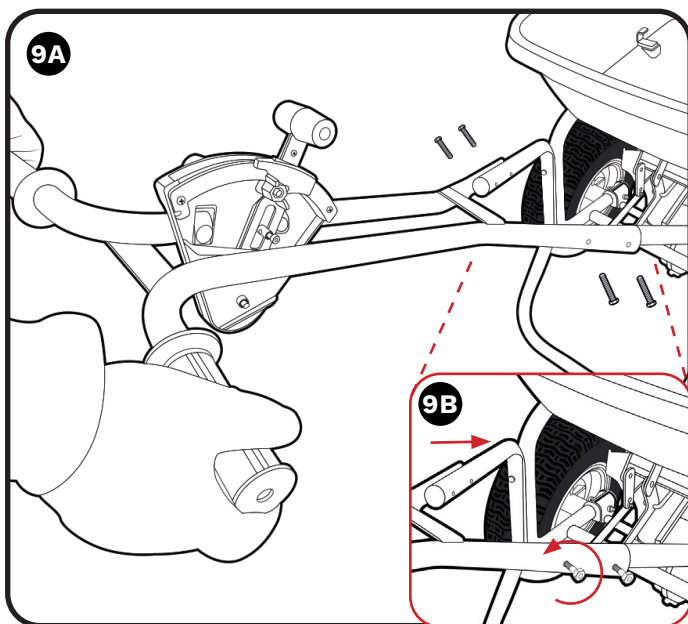

Turn the spreader over onto its wheels. 9B: Remove the four bolts from the handle. 9A: Fit upper handle into backstand. Re-insert then tighten bolts.

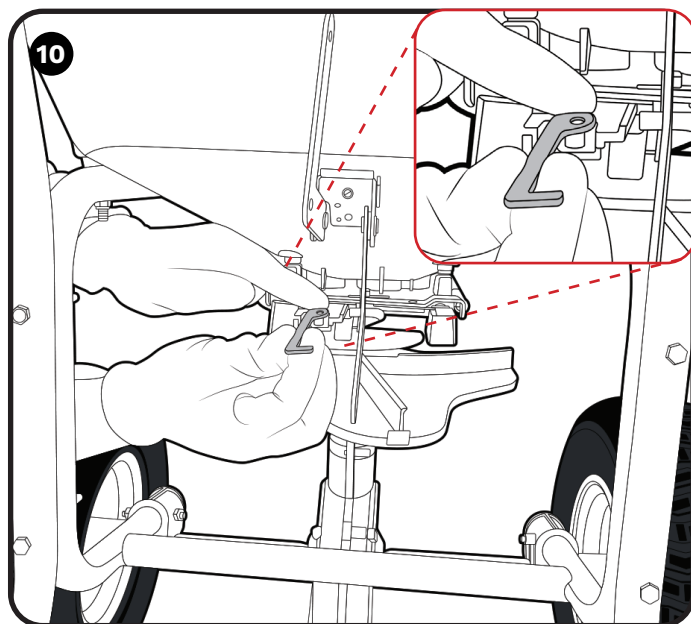

Remove the R pin (16) connecting the EdgeWise™ linkage to the pivot bracket and separate linkage from bracket. Place the large circular end of the EdgeWise™ linkage (15) over the raised peg on the black sliding plate as shown.

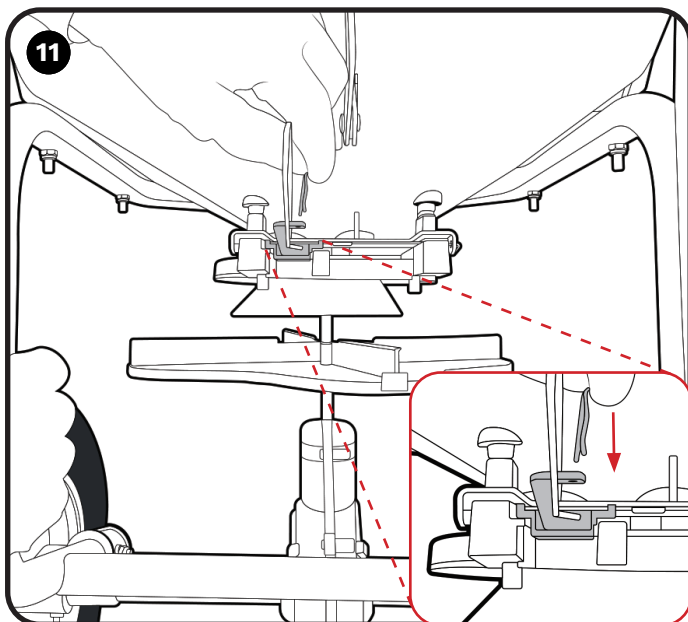

Feed small end of EdgeWise™ linkage (15) back through the hole in the pivot bracket, using R pin (16) to secure in place as shown.

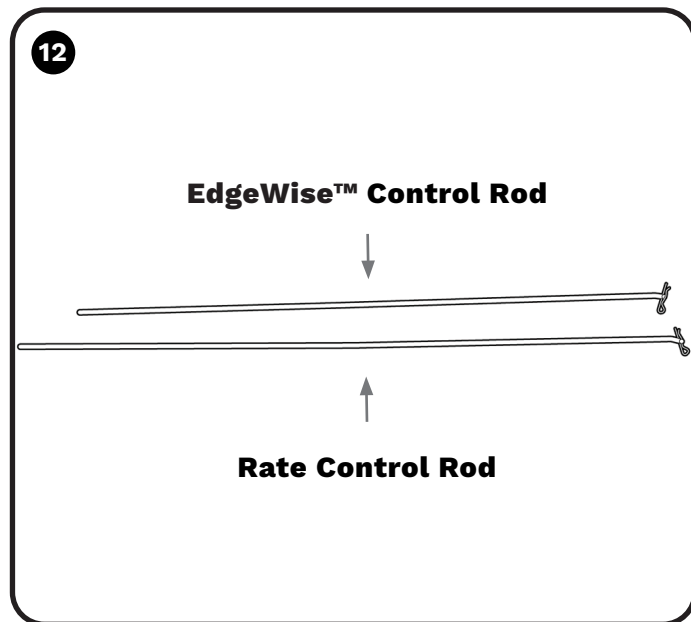

Select the EdgeWise™ control rod (4) (the shorter of the two rods) and remove the R pin.



## ASSEMBLY

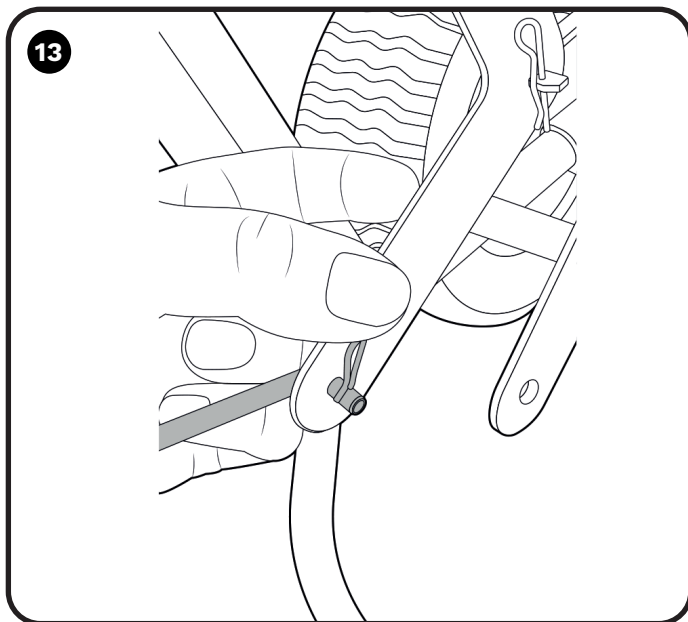

Insert the hooked end of the EdgeWise™ control rod (4) through the left side of the pivot bracket and secure with the R pin.

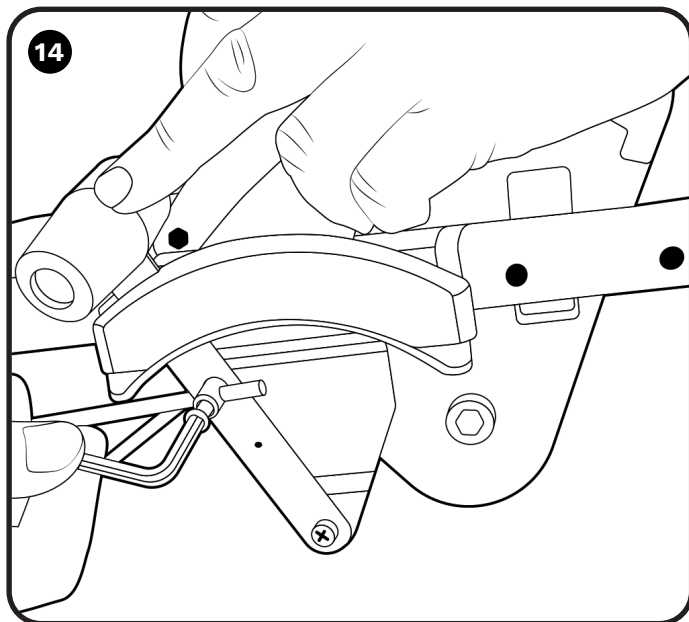

Slide the opposite end of the rod through the rod stopper on the gauge assembly. Push the on off lever to the full forward position (the on position). Using the Allen key provided (13) tighten to secure the rod in place.

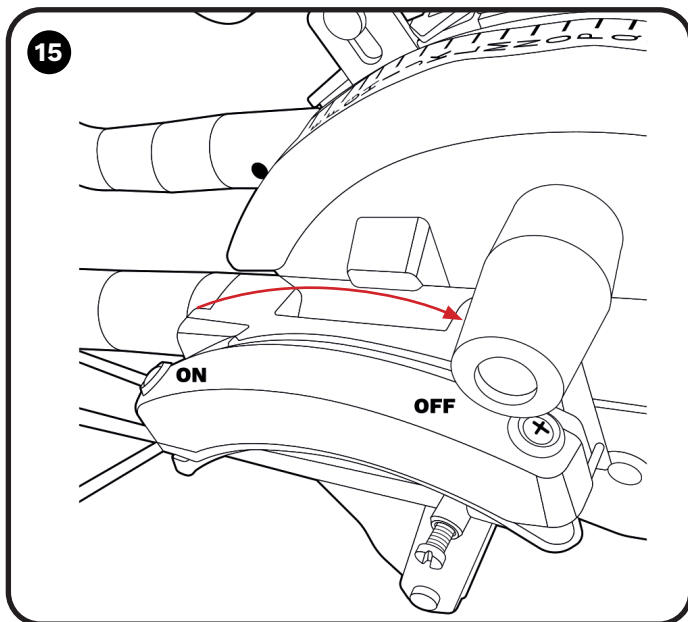

Pull the on/off lever back to the off position.

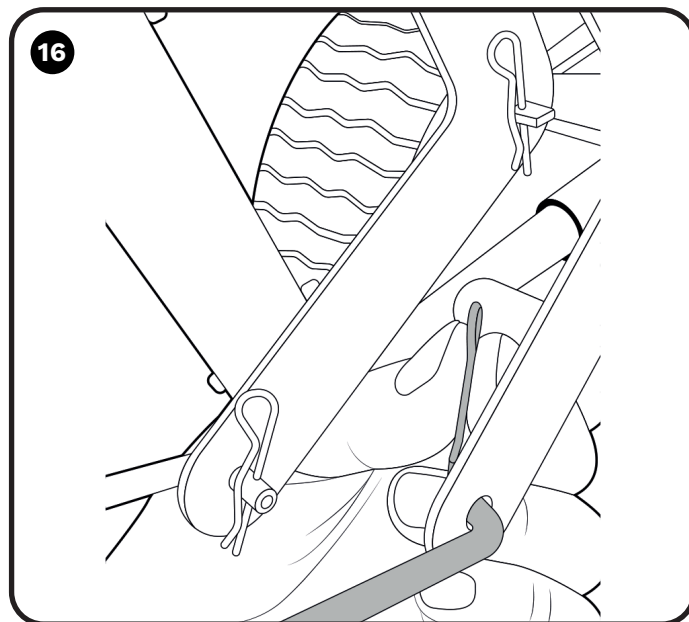

Remove the R pin from the rate control rod (5). Insert the hook end of the rod through the remaining pivot bracket. Place the R pin through the hole in the rod. The two R pins should now be facing each other on the inside of the two pivot brackets.

## CALIBRATION CHECK

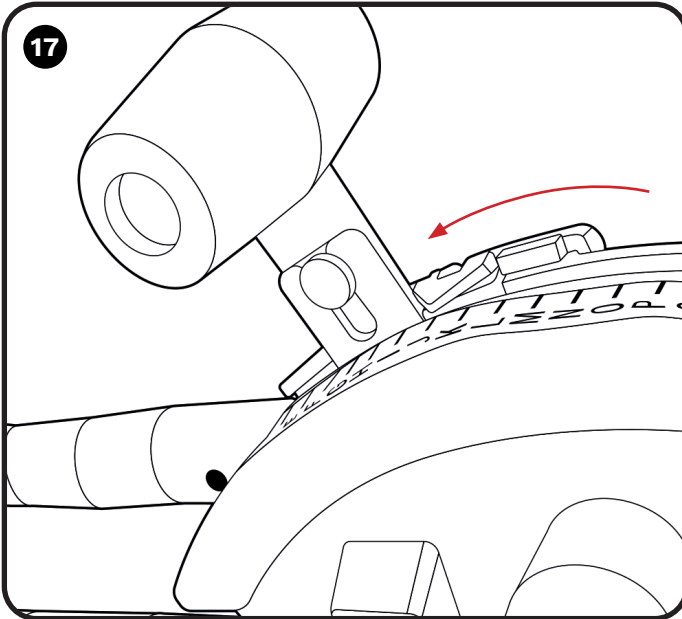

Place rate control lever in the fully forward position (closed).

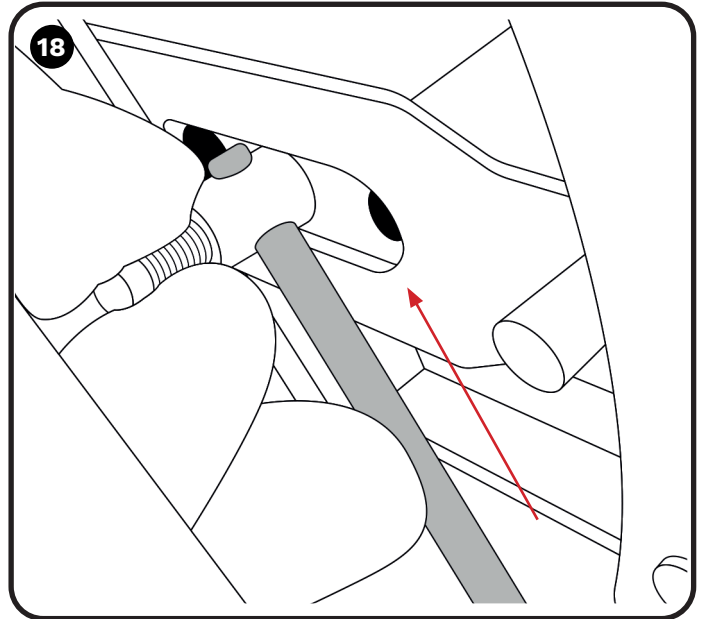

Slide Rod (5) through the rod stopper on the gauge assembly. Use Allen key to fully tighten.

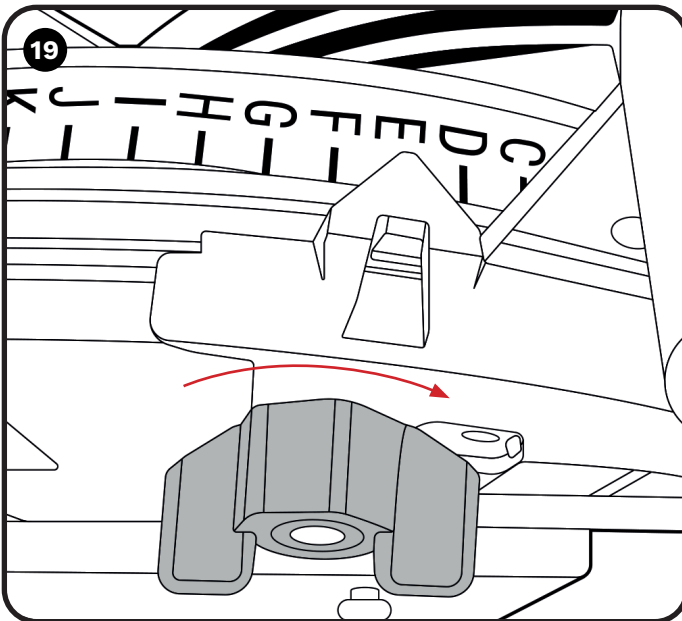

Set the lock on the gauge assembly at letter E and tighten the wing nut to lock. Open the rate control to E.

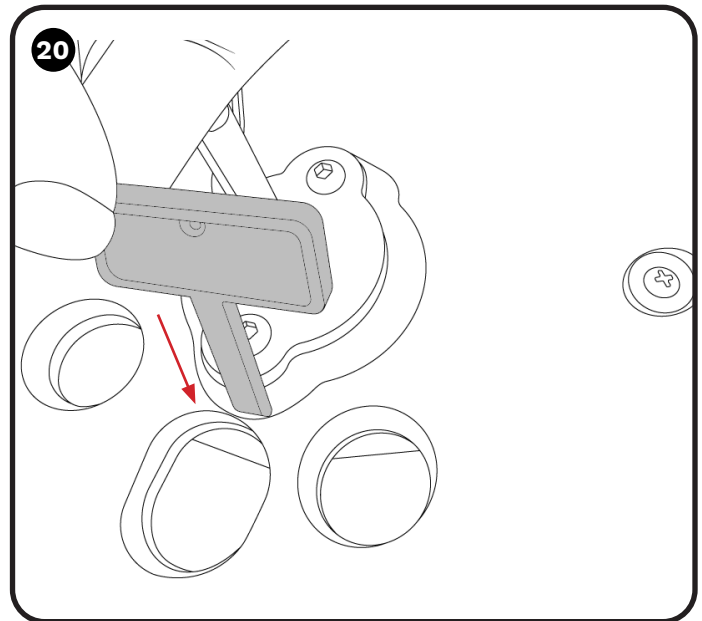

With the gauge set at "E" and the rate control in the open position, the orange calibration key should fit into the center hole as shown.

## CALIBRATION CHECK

21

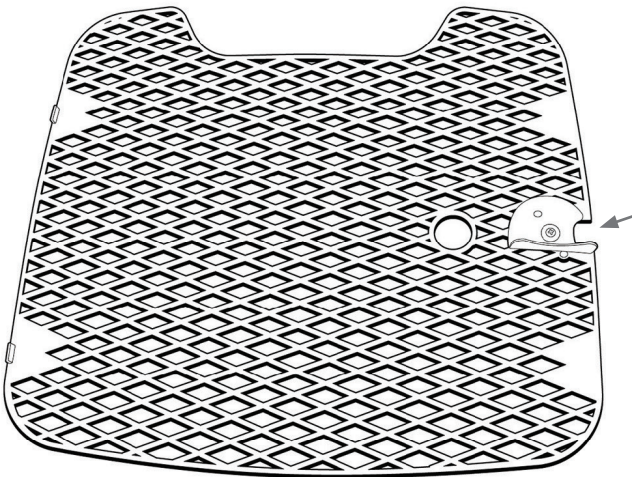

Install the screen by placing it in the hopper and turning the key arrowed above to lock.

**Assembly is complete.**



# OPERATING

- 1 Refer to product bag for cone rate setting (1-9). This is done by shifting indicator to desired number.
- 2 Refer to bag for recommended rate setting. The rate setting is achieved by loosening the rate control knob and sliding indicator to desired letter.
- 3 Ensure the rate control is closed (forward) prior to filling hopper.
- 4 To lock the rate control in the open position, pull back and up on the t-bar. ROLL SPREADER FORWARD BEFORE LOCKING IN THE OPEN POSITION, AS MATERIAL STARTS FLOWING IMMEDIATELY. To stop material flow, push down on the t-bar, and the shut off will spring closed.
- 5 Hold the handle so the hopper is parallel to the ground to ensure accurate spreading.
- 6 The settings are determined by a brisk walking pace (3 MPH). Never open shut off while pulling backwards.
- 7 The settings given on the product label are recommended starting points. TEST RATE AND PATTERN ON A SMALL AREA BEFORE TREATING A LARGE AREA. ACTUAL APPLICATION RATE CAN VARY DEPENDING ON WEATHER, SPREADER CONDITION, WIND AND WALKING SPEED.
- 8 The EdgeWise™ side spread control is designed to block material from flowing to the right side. Engage this feature by shifting the EdgeWise™ lever forward.
- 9 Once spread width is determined, overlap pattern as shown to ensure proper coverage.
- 10 A hopper cover is provided with your new spreader. Use it to protect products inside the hopper from light rain or windy conditions during transportation.

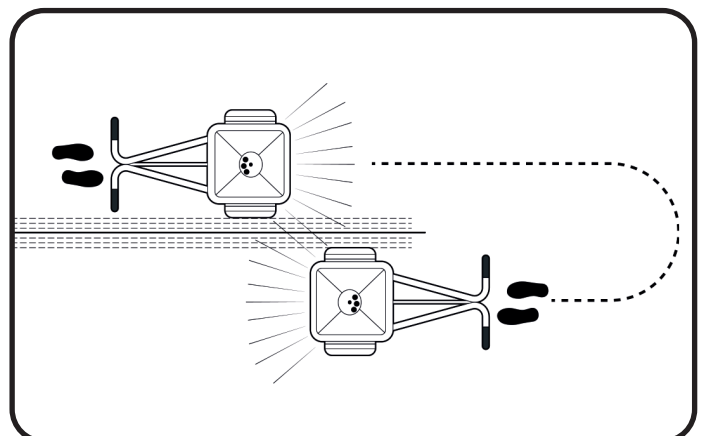
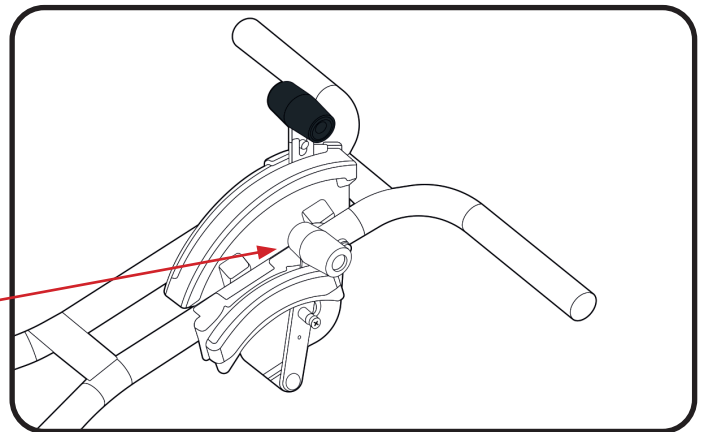
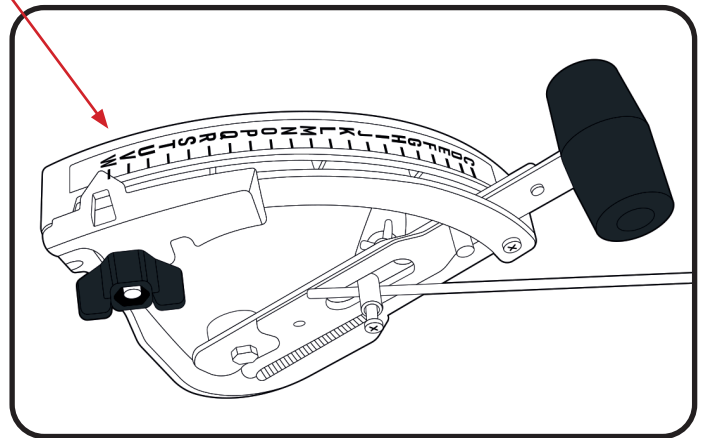
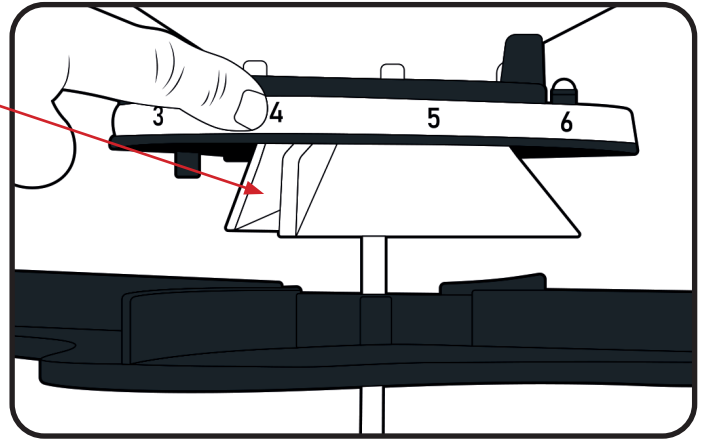

# EXPLODED PARTS DIAGRAM

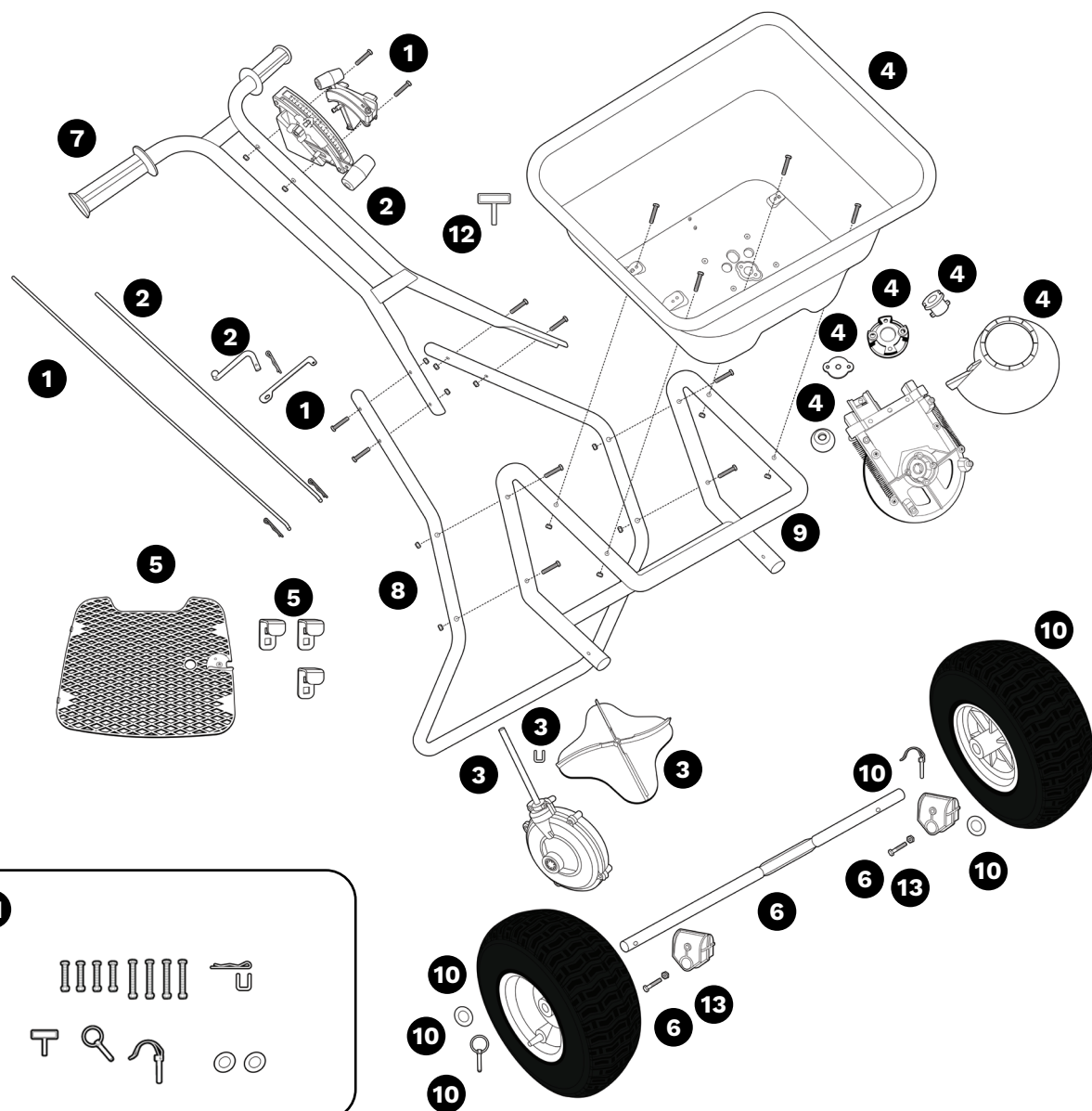

## PARTS LIST:

- |                                  |   |
|----------------------------------|---|
| <b>1.</b> EdgeWise™ Control Rod  | <b>8.</b> Back Stand                      |
| <b>2.</b> Rate Control           | <b>9.</b> Frame                           |
| <b>3.</b> Gearbox Assembly       | <b>10.</b> Wheel + Both Clips + 2 Washers |
| <b>4.</b> Hopper Assembly W/Cone | <b>11.</b> Hardware Pack                  |
| <b>5.</b> Screen Assembly        | <b>12.</b> Calibration Key                |
| <b>6.</b> Axle Assembly          | <b>13.</b> Bushing Pack                   |
| <b>7.</b> Handle                 |   |

## PART PACKS - WHAT'S INCLUDED

1

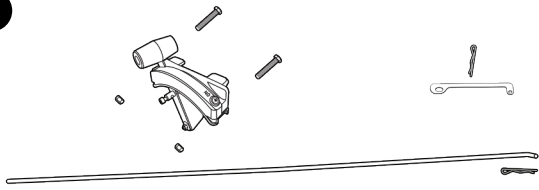

2

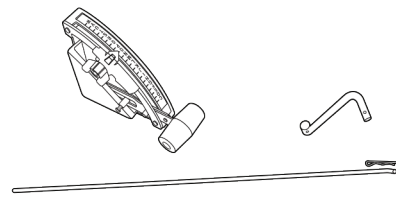

3

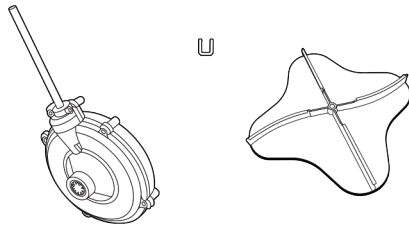

4

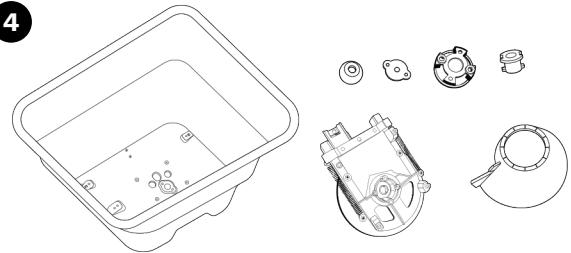

5

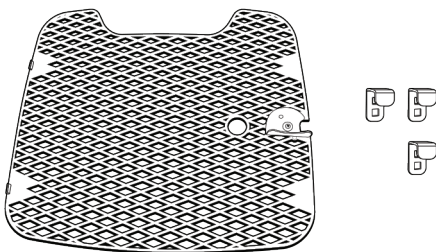

6

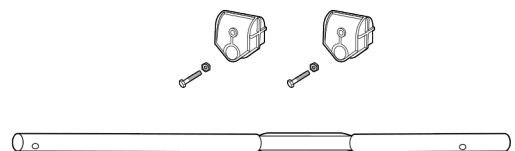

7

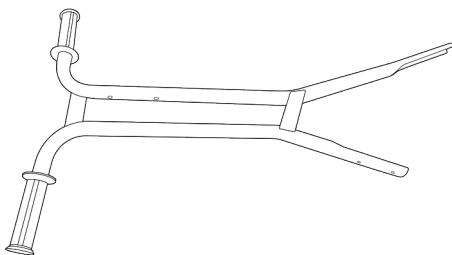

8

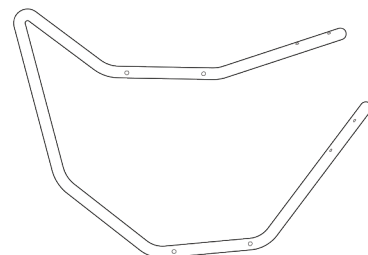

9

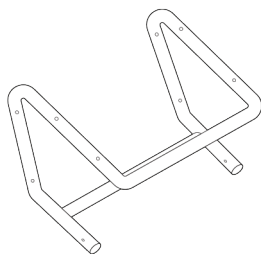

10

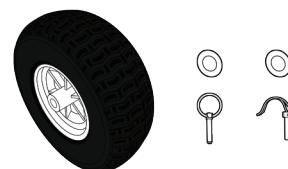

11

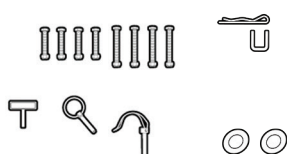

12



13

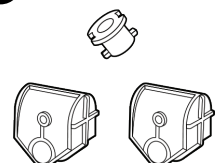

# WARRANTY

## THE ANDERSONS WARRANTS TO PURCHASER THE FOLLOWING:

1. Product will be free of defects in materials and workmanship for a period of three years from date of purchase.
2. The gear case (axle gear/pinion gear) have a Limited Lifetime warranty to be free of defects in material and workmanship.
3. If the spreader is used for commercial rental the Limited Warranty shall be limited to a period of 90 days.
4. All Unit and part replacement will be performed at the reasonable discretion of The Andersons.
5. Labor charges are not covered and the unit need not be returned to the dealer for warranty service.
6. Proof of purchase must be supplied to The Andersons.
7. For warranty questions, contact The Andersons at 800-253-5296.

The Andersons sole obligation under this warranty is limited to repairing or replacing the defective part.

This warranty does not extend to any Product or parts thereof that have been allowed to corrode, subjected to misuse, neglect, accident, or modification by anyone other than The Andersons or that have been affixed to any nonstandard accessory attachment or that have been used, stored, installed, maintained operated in violation of The Andersons instructions or standard industry practice. No agent, employee or representative of The Andersons has any authority to bind The Andersons to any affirmation, representation or warranty concerning the Product and any affirmation, representation or warranty made by any agent, employee or representative shall not be enforceable by Purchaser.

**THIS WARRANTY EXTENDS ONLY TO THE ORIGINAL PURCHASER AND IS EXPRESSLY IN LIEU OF ANY OTHER EXPRESS OR IMPLIED WARRANTIES, INCLUDING WITHOUT LIMITATION ANY IMPLIED WARRANTY OR MERCHANTABILITY OR FITNESS OR INTENDED USE FOR A PARTICULAR PURPOSE AND OF ANY OTHER OBLIGATION ON THE PART OF THE ANDERSONS. THE ANDERSONS SHALL NOT BE LIABLE FOR ANY INCIDENTAL, SPECIAL OR CONSEQUENTIAL LOSS, DAMAGE OR EXPENSE DIRECTLY OR INDIRECTLY ARISING FROM THE USE OF ANY OF THE PRODUCT INCLUDING, BUT NOT LIMITED TO, DAMAGE OR LOSS OF OTHER PROPERTY OR EQUIPMENT, LOSS OF PROFITS OR REVENUE, COST OF CAPITAL, COST OF PURCHASED OR REPLACEMENT GOODS, OR CLAIMS OF CUSTOMERS OF PURCHASER.**

It is our first priority to improve our products' quality and performance whenever possible.  
Your comments and questions are always welcome - Please call our Helpline: 800-253-5296 (U.S. Only)

or visit our website at  
[www.andersonspro.com](http://www.andersonspro.com)

Log serial number \_\_\_\_\_



The Andersons Inc. 1947 Briarfield Blvd. Maumee, Ohio 43537